

CURRENT 25.0 Ampere
 VOLTAGE RANG 50 to 1000 Volts

GBPC2501W THRU GBPC2510W

Features

- This series is SGS listed under the Recognized Component Index, file number SZXEC1902259902
- Integrally molded heat sink provide low thermal resistance for max. heat dissipation
- High surge current capability
- Void-free junction soldering by using vacuum soldering
- Universal 3-way terminals : snap on, wire-around, or P.C. board mounting
- High temperature soldering guaranteed : 260° C/10 seconds at 5lbs. (2.3kg)tension
- AI plate plastic case

Mechanical Data

Case : Molded plastic with heat-sink integrally mounted in the bridge encapsulation
 Terminals : Either nickel plated 0.25". Faston lugs or copper leads 0.040" diameter sufficient letter "W" added to indicate leads
 Polarity : Polarity symbols marked on body
 Mounting Position : Bolt down on heat-sink with silicone thermal compound between bridge and mounting surface
 Weight : 15 grams or 0.53 ounce
 Mounting Torque : 20 in.-lb. max

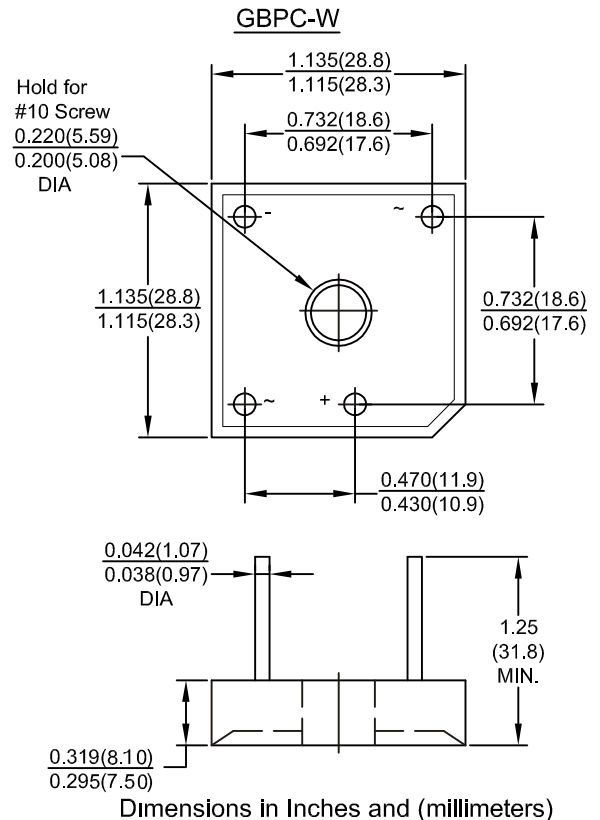

MAXIMUM RATINGS AND ELECTRICAL CHARACTERISTICS

Rating at 25° C ambient temp. unless otherwise specified.
 Single phase, half sine wave, 60 Hz, resistive or inductive load.
 For capacitive load, derate current by 20 %.

Characteristic	Symbol	GBPC							Units
		25005W	2501W	2502W	2504W	2506W	2508W	2510W	
Maximum recurrent peak reverse voltage	V_{RRM}	50	100	200	400	600	800	1000	Volts
Maximum RMS voltage	V_{RMS}	35	70	140	280	420	560	700	Volts
Maximum DC blocking voltage	V_{DC}	50	100	200	400	600	800	1000	Volts
Maximum average forward rectified current at TC=50° C	I_O	25.0							Amps
Peak forward surge current, single sine-wave on rated load(JEDEC Method)	I_{FSM}	300.0							Amps
Rating for fusing(1ms<tm<8.3ms)	I^2t	375.0							A ² sec
Maximum instantaneous forward voltage drop per leg at 12.50 A	V_F	1.1							Volts
Maximum DC reverse current at rated DC blocking voltage per leg	I_R	5.0 500							μ A
RMS isolated voltage from case to leads	V_{ISO}	2500							Volts
Typical junction capacitance	C_j	300							pF
Typical thermal resistance	R_{th-JC}	1.9							° C/W
Operating junction and storage temperature range	T_j, T_{stg}	-55 to +150							° C

Notes : 1. Measured 1MHz and applied reverse voltage of 4.0V DC

CURRENT 25.0 Ampere
 VOLTAGE RANG 50 to 1000 Volts

GBPC2501W THRU GBPC2510W

Rating and Characteristic Curves (TA=25°C Unless otherwise noted)

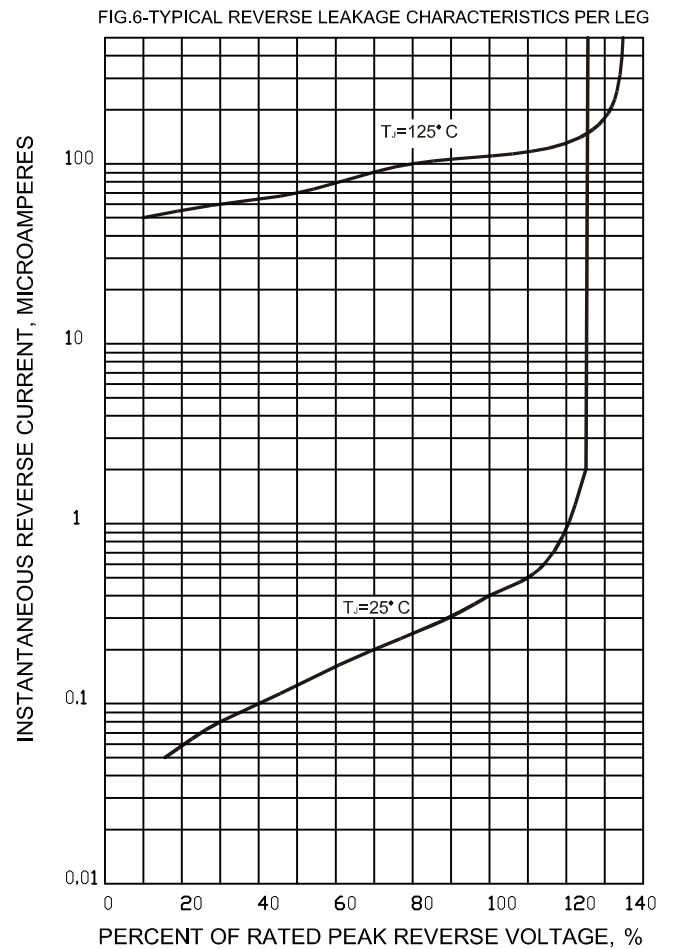
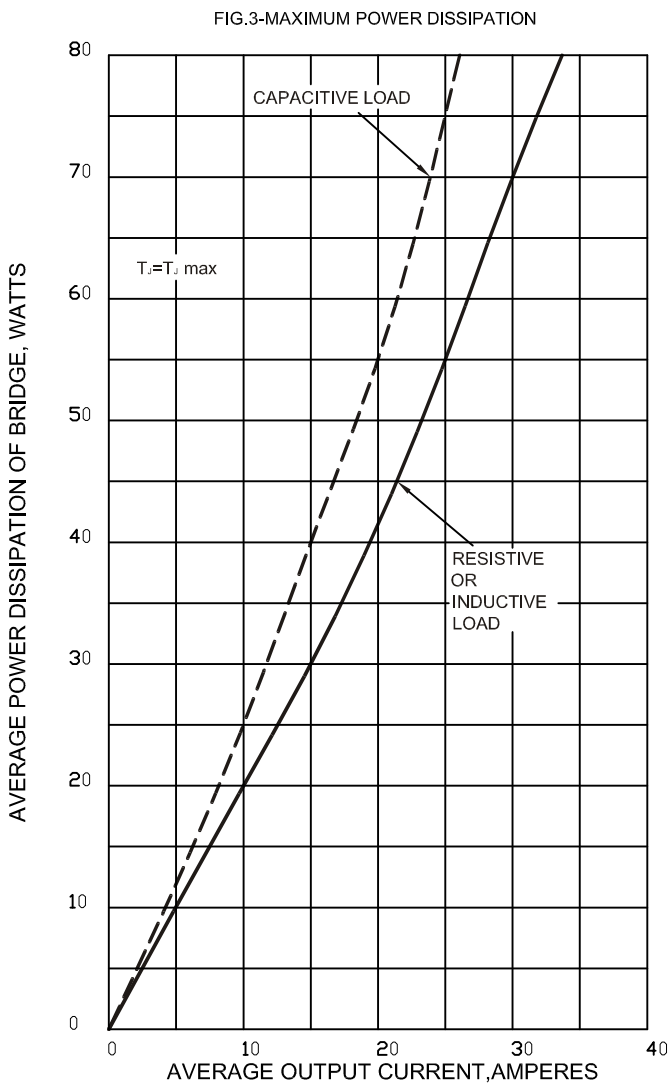
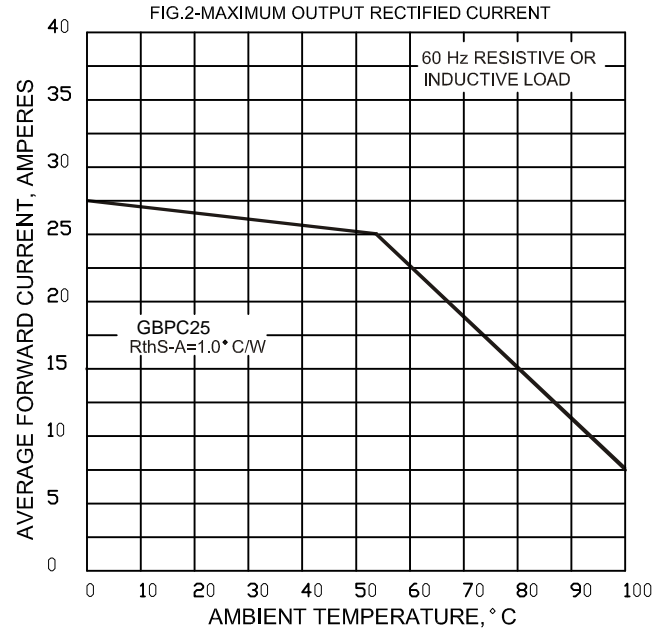
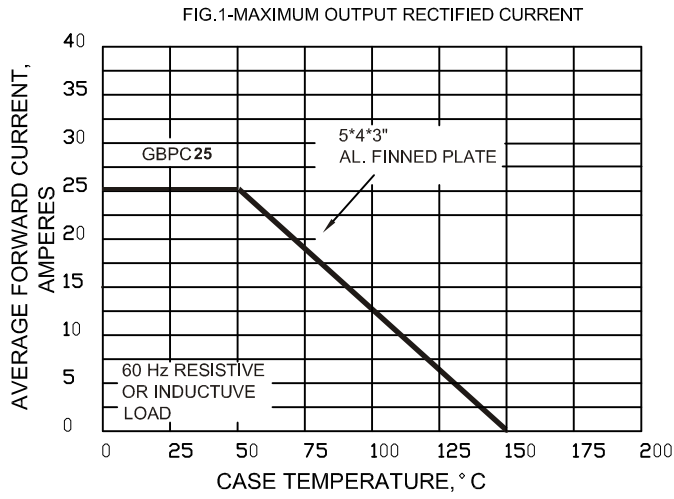

CURRENT 25.0 Ampere
 VOLTAGE RANG 50 to 1000 Volts

GBPC2501W THRU GBPC2510W

Rating and Characteristic Curves (TA=25°C Unless otherwise noted)

FIG.4-MAXIMUM NON-REPETITIVE PEAK FORWARD SURGE CURRENT PER LEG

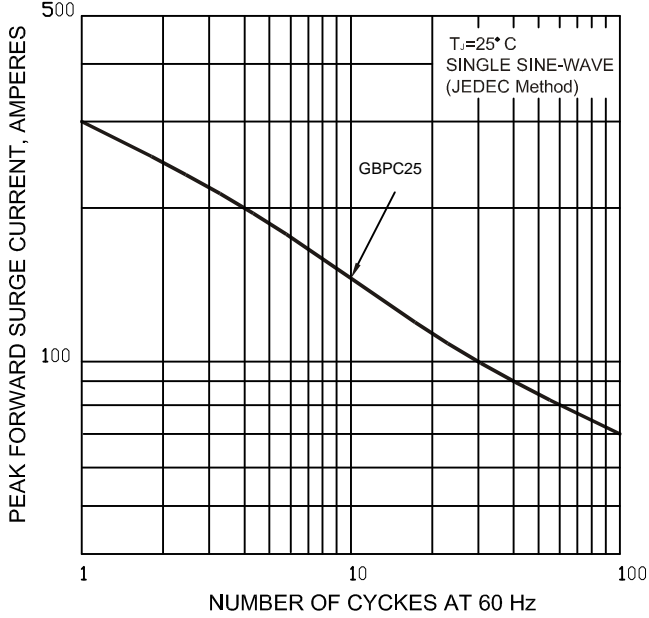

FIG.5-TYPICAL INSTANTANEOUS FORWARD CHARACTERISTICS PER LEG

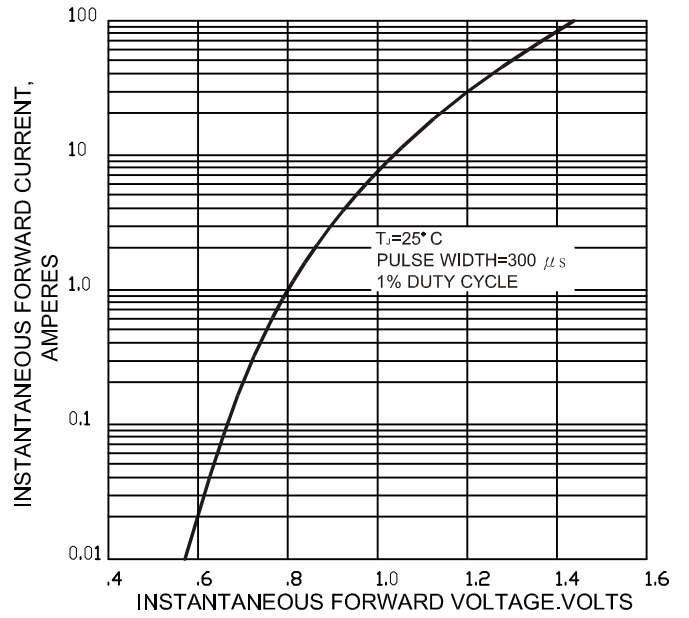

FIG.7-TYPICAL JUNCTION CAPACITANCE PER LEG

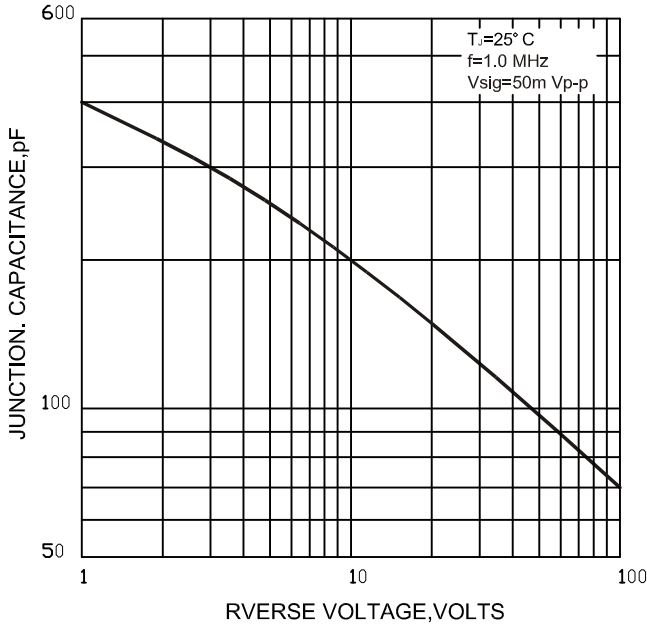

FIG.8-TYPICAL TRANSIENT THERMAL IMPEDANCE PER LEG

